

## Description

Design – covered float

Material – antimagnetic stainless steel

The basic construction component is a flange welded to two co-axial tubes. The inner tube contains a measuring system with magnetic switches. A float with a magnet moves along this tube and operates the magnetic switches. As a result, the output value of the selected electrical quantity depends on the fuel level height.

The outer tube serves as a protection of the float, and, in addition, dampens the impact of sudden changes of fuel levels on measurement, for example at turning of construction machines.

The Fuel Sensor can be equipped with a reserve switch.

The measurement system can be connected as a rheostat or as a voltage divider.

The Fuel Sensor is intended for mounting to tanks with a 40mm hole.

The use of a fuel gauge must be specified in the order.



## Parameters:

Max. voltage	32	V
Max. current terminal 1	50	mA
Max. current terminal 2	200	mA
Operating temperature	-40°C thru +85°C	°C
Storage temperature	-40°C thru +85°C	°C
Label	producer, product code, date (or date code)	
Vibration resistance	3	g
Service life	1 000 000	cycles
Protection degree	IP 68 (inner part)	IP 67 (external part)

## Overview of manufactured types

Type	height [H]	reserve	L1	L0	Number of measuring steps	R		Connector	Flange
						max	min		
						[ohm]			
measured from flange [mm]						state 0	state 1		
GW 7-4011	522	479	30	489	24	94,1±2%	max. 1	3x Faston 6,3	SAE J1810
GW 7-4012	278	245	30	239	13				
GW 7-4013	522	-	30	489	22				
GW 7-4014	634,5		30	601	27	79±1,6%			
GW 7-4015	478,5	479	30	445	20	85,9±1,6%	0,5±0,4%		
GW 7-4016	522		60	489	21	94,1±2%			
GW 7-4017	614	-	30	581	26	76,3±1,6%	0,4±0,4%		
GW 7-4018	811		30	777	34	70,6±1,6%			
GW 7-4019	881		30	847	37				
GW 7-4111	522	479	30	489	24	94,1±2%	max. 1	Super Seal	
GW 7-4112	278	245	30	239	13				
GW 7-4113	522	-	30	489	22				
GW 7-4114	634,5	-	30	601	27	79±1,6%	max. 1		
GW 7-4115	478,5		30	445	20	85,9±1,6%			
GW 7-4116	522	479	60	489	21	94,1±2%	0,5±0,4%	Super Seal	SAE J1810
GW 7-4117	614		30	581	26	70,6±1,6%			
GW 7-4118	811		30	777	34				
GW 7-4119	881	-	30	847	37	250±2%	30±2%	Deutsch DT04-2P	
GW 7-4120	780		30	747	33				

GW 7-4121	405	30	369	17	73,1±2%	max. 1	Super Seal
-----------	-----	----	-----	----	---------	--------	------------

Other types can be prepared according to customer requirements within the limit parameters stated below:

### Limit parameters for specifying new types by the customer

Max. length H	1200	mm
Measuring circuit resistance	50 – 100 000	ohm
Minimum measurement step	10	mm
Max. measured height L1	18	mm
Min. measured height L0	H - 30	mm
Connector	Any type of cable connector	

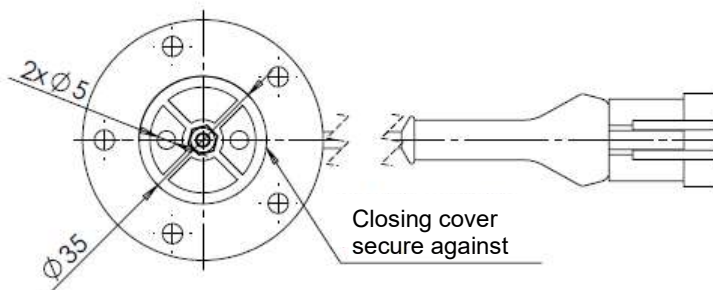

Variant B

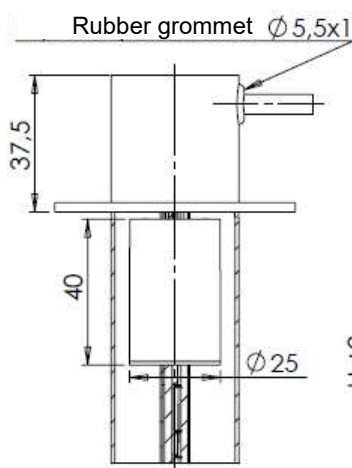

Variant A

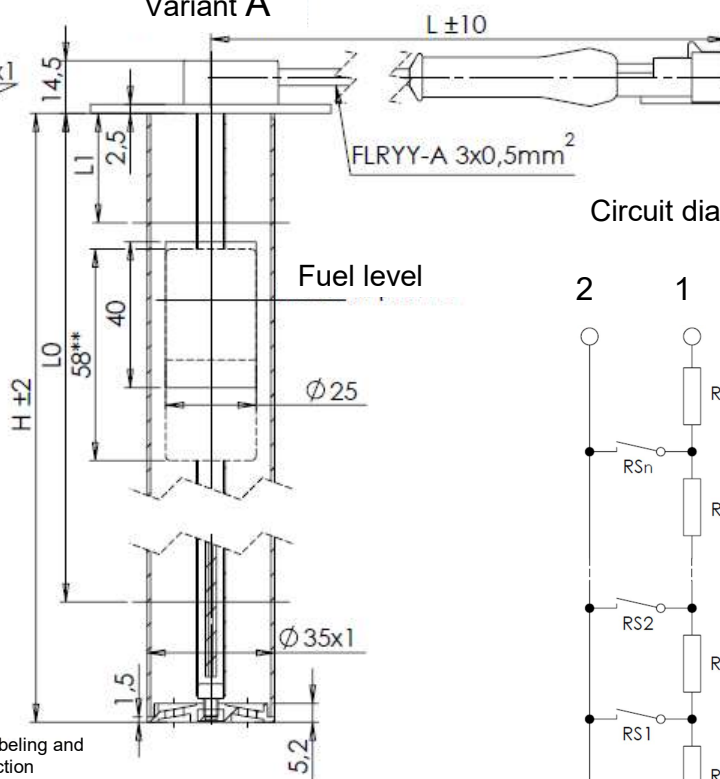

Circuit diagram

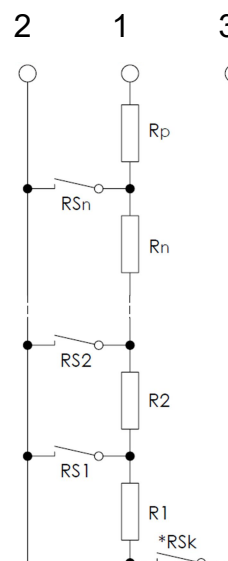

Example of labeling and date of production in accordance with EN 60062

YY - year  
WW - week  
NNN - serial number

